

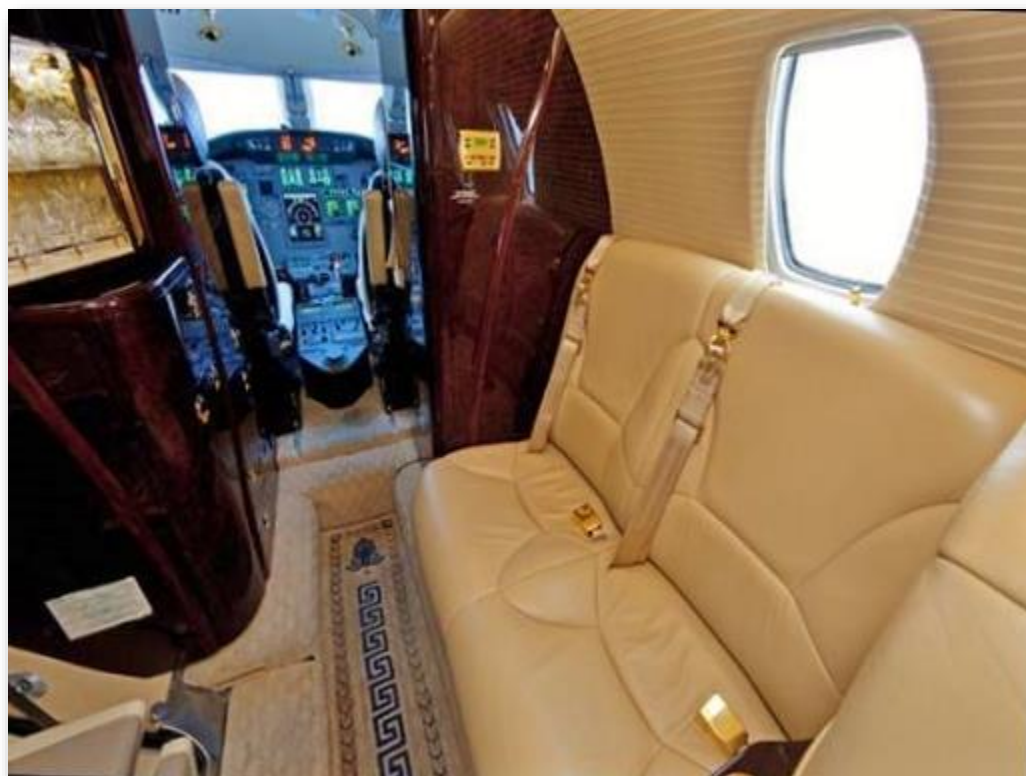

Divan Catalog

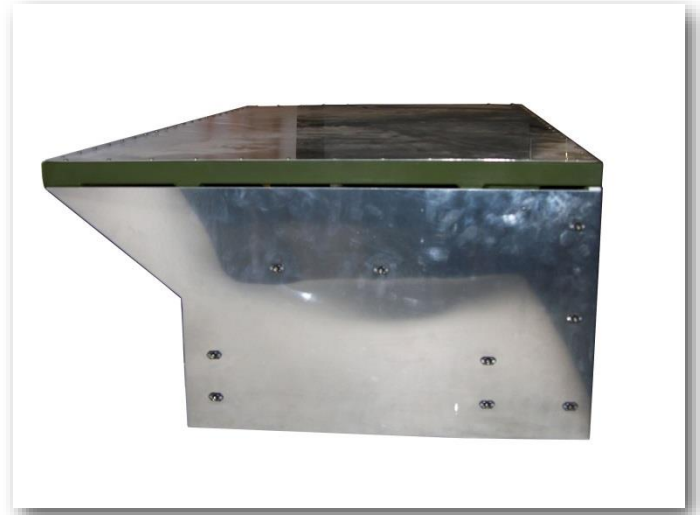





Gulfstream I, II, III, IV Divans

Standard Gulfstream Divan:

62-0283, 1 Place Divan, 21.75" length

62-0284, 2 Place Divan, 42.75" length

62-0285, 3 Place Divan, 63.75" length

The 4 Place Divan is comprised of (2) P/N 62-0284 installed end to end

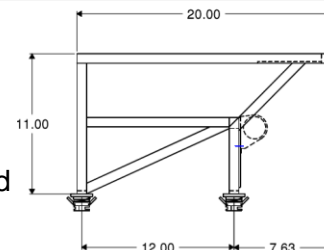

Deluxe Gulfstream Divan features an inboard overhang that provides more seating area, increased under-seat stowage volume and is designed to allow greater clearance from the outboard wall for some later model airplanes that have larger ductwork.

62-0402, 1 Place Deluxe Divan, 22" length for installation with Gulfstream "Brownline" track.

62-0402K-1 1 Place Divan 22" length for installation with Gulfstream "G" track.

62-0403, 2 Place Deluxe Divan, 38.5", 40", 41.5", or 43" for installation with Gulfstream "Brownline" track

62-0403K-1 2 Place Deluxe Divan 38.5", 40", 41.5", or 43" length for installation with Gulfstream "G" track.

The 3 Place Deluxe Divan is comprised of (1) P/N 62-0402 & (1) 62-0403 installed end to end

The 4 Place Deluxe Divan is comprised of (2) P/N 62-0403 installed end to end

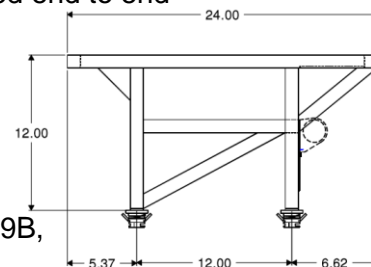

APPLICABLE AIRCRAFT: Gulfstream G-159, G-1159, G-1159A, G-1159B, and G-IV.

OPTIONS: Plug-in arm rests, Arm box with drink holders, Under seat storage drawers
Close-out panels with or without latched doors

APPROVAL TYPE: Federal Aviation Administration Parts Manufacture Approval and Supplemental Type Certificate (STC) SA2893SW eliminating the need for field approval.

FEATURES: All side-facing divan kits include integral inertia reel restraint system, track feet, installation instructions, etc. Divan is delivered in "green" condition, without upholstery..

INSTALLATION: Installation involves the removal of existing seat/s and furnishings, locating the new divan or divans in the desired location, and locking them in the seat track (complete installation instructions, and diagrams are included). Installer is responsible to research the Gulfstream loading service bulletin to determine if floor structure is substantiated where the installation is desired.

LEAD TIME: We are proud of our two-week lead-time reputation. However, fluctuations in demand may cause up to a 30 day delivery delay.

TRADE - IN: Existing cabin chair/s and/or furnishings removed for installation of the divan may have a substantial trade-in value (based on aircraft model and year of manufacture, condition, completeness, etc.) Please call for quote.





Gulfstream I, II, III, IV Divans

Options



Plug-in Arm Rest



**Arm Box
with Cup Holders**

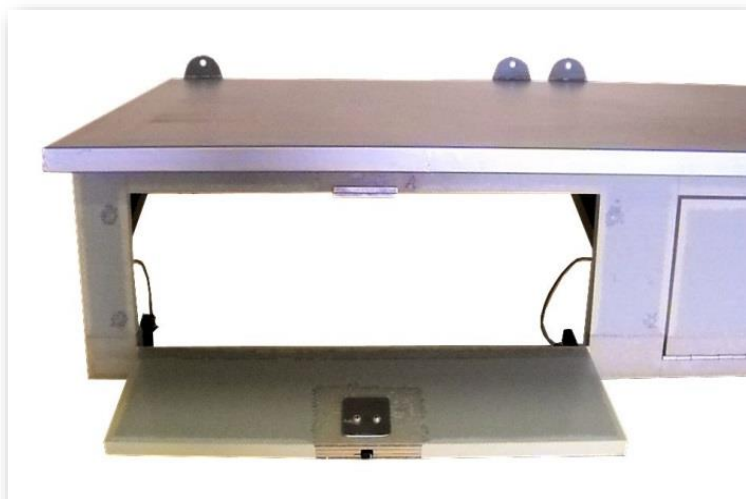

Close-out Panels



**Sliding Storage
Drawers**





Gulfstream Divans





Learn more about Avfab's comprehensive line
of Gulfstream products & services at
www.AvFab.com



Signature Quality



Aviation Fabricators

805 North 4th Street
Clinton, MO 64735
(660) 885-8317
www.AvFab.com

